

London Pattern Brick Trowels
Durasoft® Handle

- Resilient, durable DuraSoft® handle reduces fatigue
- Hard polymer bumper is virtually indestructible
- Integral finger guard protects against calluses, heat, and cold
- Forged from a single piece of high carbon tool steel
- Impact area is stronger to provide extra endurance
- Handle rise is set for the correct hang and balance

10123 11" Brick Trowel 33 11FG
 10124 11-1/2" Brick Trowel 33 11.5FG
 10125 12" Brick Trowel 33 12FG



Finishing Trowel
Durasoft® Handle

Resilient DuraSoft® handle provides a soft feel, reduces fatigue, and offers excellent durability

13229 MXS64D 14" x 4"
 13249 MXS66D 16" x 4"
 13269 MXS81D 18" x 4"



Pointing Trowel
Durasoft® Handle

- Forged from a single piece of high carbon steel
- Tempered, ground, and polished
- DuraSoft® handle provides a soft feel, reduces fatigue & offers excellent durability

11127 6" Pointing Trowel 45 6D



Margin Trowel
Durasoft® Handle

- Forged from a single piece of high carbon steel
- Tempered, ground, and polished
- DuraSoft® handle provides a soft feel, reduces fatigue & offers excellent durability

11198 5" x 2" Margin Trowel 52D



Zinc Groover

- High quality long wearing zinc
- Harder than bronze
- Finely finished to cut sharp clean grooves
- DuraSoft® handle provides a soft feel, reduces fatigue & offers excellent durability

14106 1/4" rad., 3/8" w, 3/4" d
 Zinc Groover 834D
 14107 1/4" rad., 3/8" w, 1" d
 Zinc Groover 835D



Blue Steel Edger

- 6 in. x 4 in.
- Straight ends

13970 1/4" rad. & 3/8" lip BS Edger CE555B
 13972 3/8" rad. & 1/2" lip BS Edger CE556B
 13974 1/2" rad. & 5/8" lip BS Edger CE557B
 13952 5/8" rad. & 7/8" lip BS Edger CE541B



Sidewalk Edger

- 6 in. x 4 in.
- Comfortable handle securely attached
- Straight ends

13898 1/2" rad. & 5/8" lip SS Edger CE509S
 13900 3/4" rad. & 7/8" lip SS Edger CE510S



Molded Rubber Float

- Ideal for bringing sand to the surface
- Molded black rubber pad
- Float face is permanently cemented to the lightweight aluminum backing
- Smooth handle
- Used by concrete finishers and plasterers

14408 Molded Rubber Float 40



Coarse Cell Rubber Float

- For a rough or textured finish
- 5/8" thick red rubber pad bonded to the aluminum backing plate
- Securely attached comfortable handle

14406 Coarse Rubber Float 39



Magnesium Float, Round Ends

Durasoft® handle

- Hard, durable, lightweight magnesium
- Comfortable handle
- Perfect balance
- Produces a smoother finish than wood
- Fully rounded ends prevent float marks

14612 16" x 3-1/8" Mag Float 143D



Magnesium Float, Beveled Ends

Durasoft® handle

- Use with air entrained concrete
- Hard, durable, lightweight magnesium
- Comfortable handle
- Perfect balance
- Produces a smoother finish than wood

14610 16" x 3-1/8" Mag Float 145D

If You Don't See It, Call And Ask About Our Special Order Program



48" Magnesium Bull Float

- Extruded from magnesium alloy
- Lightweight, long wearing

13874 Mag Bull Float MB48



Bull Float Bracket 4 Hole Assembly

19166 Bull Float Bracket Assembly A3003



72" Bull Float Handles

14804 Threaded Handle B5 72
14807 Push Button Handle PB72L



Tuck Pointer

- Forged from one piece of high carbon steel
- High shank & lift for extra hand room
- Securely attached hardwood handle with metal ferrule

11315 6-3/4" x 3/8" Tuck Pointer 11315



19" Pul-Krete w/Handle

- Blade of 12-gauge cold rolled steel
- Comes with 54" hardwood handle

13877 Pul-Krete W/Handle CM419



15" x 1/2" Sled Runner Solid Half Round

- Solid construction with heavy gauge steel mounting
- Wood handle securely attached
- Specifically designed for finishing horizontal joints
- Ends are curved up so you can use it in either direction

16548 Sled Runner 609



Brick Jointer

- Made from high carbon steel
- Convex face for striking concave joints
- Each end is a different size
- 10-1/2" in length

15528 3/8" x 1/2" Brick Jointer 83
15522 1/2" x 5/8" Brick Jointer 80
15524 3/4" x 7/8" Brick Jointer 81
15526 5/8" x 3/4" Brick Jointer 82



Bull Float Brackets RotaLeveler®

- Fits any bull float without adapters
- Features easy control adjustment
- Large protected grease reservoir
- Accepts most 1-3/4" and 1-3/8" push button handles without adapters

14801 Rotaleveler RL6



Bull Float Groover Attachment

- Made from durable hardened aluminum
- Thumbscrew attachment
- Slides easily over magnesium bull float
- Form grooves or expansion joints

14710 1/4" rad., 3/4" d
BF Groover Attachment 4710



Joint Raker

- Large 1-3/4" skate wheels
- Strong aluminum handle contoured to fit the hand
- Hardened nail, adjustable
- Securely tighten by slipping the nail in the eye of a spade bolt and twisting

15502 Joint Raker 89



Barrel Jointer Set

- Includes 4 popular sizes of changeable steel barrels - 1/2", 5/8", 3/4", & 7/8"
- Easy to change threaded barrels

10850 Barrel Jointer BJ850

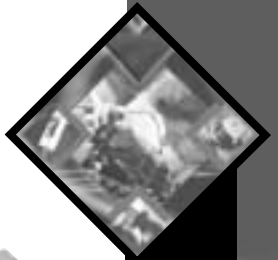

Brick Trowels

One piece forging from the highest grade trowel steel; tempered, taper ground and polished; set for correct balance with custom fitted hardwood handle.

- BL705 11" NI Brick Trowel Wood Handle
- BL706 11-1/2" NI Brick Trowel Wood Handle
- BL707 12" NI Brick Trowel Wood Handle

Narrow London Pattern Trowels - W. Rose™

- RO116-11 Rose Trowel Narrow London 11" Wood Handle
- RO116-11 1/2 Rose Trowel Narrow London 11-1/2" Wood Handle
- RO116-12 Rose Trowel Narrow London 12" Wood Handle



Finishing Trowel ProForm® Handle

- Comfortable ProForm® handle
- Precision ground edge
- Guaranteed "NO TURN HANDLE"

- CF217PF 14" x 4" Cement Trowel
- CF222PF 16" x 4" Cement Trowel
- CF227PF 18" x 4" Cement Trowel



Pointing Trowel Hardwood Handle

One piece forged trowel. Made of high grade trowel steel, Tempered, ground, and polished for perfect balance and feel. Comes with hardwood handle.

GG422 5-1/2" Pointing Trowel



Margin Trowel Hardwood Handle

One piece forged trowel. Made of high grade trowel steel, Tempered, ground, and polished for perfect balance and feel. Comes with hardwood handle.

GG432 5" x 2" Margin Trowel



Bronze Groovers

All Kraft bronze groovers are meticulously crafted with belt polished surfaces that make it easy to cut sharp, clean grooves. They are long wearing and have the features professional craftsmen demand.

- CF304 6" x 4" 1/2" Big Bit Bronze
- CF314 6" x 4" 1/2" Deep Bit Bronze



Stainless Steel Sidewalk Edgers

- 6 in. x 4 in.
- Straight ends

- CF173 6" x 4", 3/8" Rad. Cem Edger
- CF165 6" x 4", 1/2" Rad. Cem Edger
- CF174 6" x 4", 3/4" Rad. Cem Edger



Blue Steel Edgers

- 6 in. x 4 in.
- Straight ends

- CF573 6" x 4", 3/8" Rad. Blue Stl Edger
- CF574 6" x 4", 1/2" Rad. Blue Stl Edger



Molded Rubber Floats

Molded black sponge rubber with a very dense texture. This popular float is made of the best quality rubber available. Comes with comfortable plastic handle.

PL395P 8" x 4" Molded Rubber Float



Coarse Cell Rubber Floats

Coarse cell red sponge rubber pad securely cemented to flat aluminum back. Comes with comfortable plastic handle.

PL374P 8" x 4" Red Rubber Float



Magnesium Float Round End w/ ProForm® Handle

This magnesium hand float has both ends rounded and broken in. It makes floating easier and does a great job floating. ProForm® handle.

CF076PF 16" x 3-1/4" .



Magnesium Float ProForm® Handle

This popular float is made of very hard and durable magnesium. The position of the handle gives the tool perfect balance. Both ends are beveled and the blade is broken in with rounded corners.

CF016PF 16" x 3-1/4"

If You Don't See It, Call And Ask About Our Special Order Program



Magnesium Bull Floats

These lightweight and long-wearing magnesium floats are made from the finest extruded magnesium. Multi-ribbed top provides extra strength. The blades are properly curved and balanced to prevent digging. Bull float can be used with EZY-Tilt® or other 4-hole threaded bracket. Use with threaded handles.

CC802-01 Blade Only 48" Mag B/F



Threaded Handle Float Bracket

Handle socket adjusts to the desired angle. Fits all 1-1/4", 1-1/2" or 1-3/4" threaded extension handles.

CC800 4 Hole Float Thread Bracket



Caulking Trowel

One piece forging. These trowels are made from high carbon steel. They are ground for flexibility and have a high shank and lift.

BL763 3/8" Caulking Trowel



Half Round Convex Sled Runners

The best tool you can get for making round sunken or rodded masonry joints. Steel blade with wood handle. 14" sled runners are turned up on one end only.

BL215 14" x 1/2"
BL229 20" x 1/2"



72" Bull Float Handles

CC236 1-3/4" Dia. Aluminum Threaded Handle

CC2895 1-3/4" Dia. Aluminum Swaged Button Handle



Concrete Spreader

Lightweight aluminum concrete spreader is 19-1/2" long. It has two braces for strength and is lightweight. Makes spreading concrete easy. Comes with 54" wood handle.

CC904 19-1/2" x 4" Aluminum Concrete Spreader w/o HK-w/HDL



Brick Jointers High Carbon Steel

Each end makes a different size joint. Overall length 10-1/2".

BL260 3/8" x 1/2" Brick Jointer
BL261 1/2" x 5/8" Brick Jointer
BL262 5/8" x 3/4" Brick Jointer
BL264 3/4" x 7/8" Brick Jointer



EZY Tilt® II Float Bracket

Made of rugged, lightweight aluminum. Pitch of blade is controlled just by turning handle. Eliminates bending and lifting. Designed to fit all (2) or (4) hole metal bull floats. No adapter needed. Use with snap-style handle.

CC294 6-hole Button Bracket



Bronze Bull Float Groover Attachment

Attaches with two thumbscrews. Use bull float as groover. Mount as many groovers as needed. Works on 8" wide bull float. 1" Bit depth, 1/4" radius, 1/2" width.

CC941 1" Bull Float Groover Attachment



Skate Wheel Joint Raker

Masons love this big wheeled joint raker. Wheels are 1-3/4" diameter, mounted 1-3/4" apart. Overall width is 3". Has 8-1/2" aluminum handle that is squared off at the end so you can rod joints. Hardened nail is adjusted for depth.

BL210 Skate Wheel Joint Raker



Hubbard Jointers

The Hubbard jointer was designed by a brick layer. More knuckle clearance, replaceable blades, long lasting. Jointer comes with one each of the following blades: 1/2", 5/8", 3/4", and 7/8". Keep the handle, replace the blades. Overall length 8-1/2". Made in USA.

BL280 Hubbard Jointer w/ 4 Blades

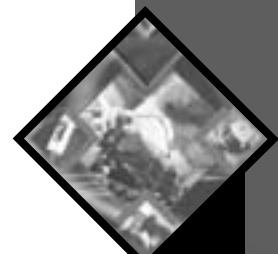

CONCRETE & MASON TOOLS



Marshalltown Brick Tongs

- Heavy duty tongs designed and built for long wear
- Can be quickly adjusted to carry from six to ten bricks
- Tongs are maintenance free

16510 Brick Tongs 88



Kraft Brick Tongs

- Heavy duty quick adjustable
- Carries 6-10 bricks
- Built for long wear
- Made in the U.S.A.

BC380 Brick Tongs-Yellow

Kraft Masonry Brushes

BL526 Red Handle Jumbo Utility Brush

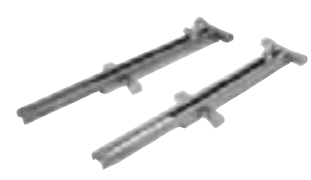

Marshalltown Line Stretchers

- Stretches masons line between key course blocks
- Fully adjustable 4" to 12"
- Made from cast aluminum

16504 Line Stretchers ALS504



Kraft Line Stretchers

- Adjusts to various size blocks from 4" to 12"
- Stretches line tight between blocks
- Made in the U.S.A.

BL147 Adjustable Line Stretchers (Pair)



Marshalltown Rub Brick

- Ideal for dressing down and removing form marks from concrete or cleaning brick
- Made in the U.S.A.

16440 20 Grit 840 6"x 3"x 1"



Rub Bricks

- Fluted silicon carbide stone
- Comfortable handle
- 20 Grit ideal for dressing down and removing form marks from concrete

CF283 20 Grit 6" x 3" x 1"



CH Hanson Mason Line

- Adjusts to fit all 1" cores from 4" to 6" long
- Re-loadable Reel system allows for each change from one line to another
- Rewind hand crank
- Reel improves accuracy and reduces labor

Pink Braided 500' 25462

Orange Braided 500' 25463

Lime Braided 500' 25464



Marshalltown Tie Wire Twister

- Safely and easily twists wire bar ties
- Rugged design

14731 Tie Wire Twister

Kraft Tie Wire Twister

- Made in the U.S.A.

GG310 Tie Wire Twister



HITACHI



Hitachi Rebar Bender/Cutter

- Utilizing 530W of power, it uniformly bends and cuts up to No.5 (3/8", 1/2", 5/8") Grade 60 rebar
- Variable speed trigger with safety lock
- Reference markings on bending plate for easy position adjustment
- Easily portable, weighing only 42 lbs.
- Low profile design (18.4"L x 8.5"H x 9.1"W), yet extremely stable
- Includes: Deflection Guard 320914, Cutter Set 319706

VB16Y Rebar Bender/Cutter

If You Don't See It, Call And Ask About Our Special Order Program

E-MAIL sales@verticalsolutions.net



Construction Poly Sheeting

- Use for concrete curing, vapor barriers, building enclosures, mulching, machinery covers
- 1 through 10 mil. thickness
- 10 through 40 ft. widths
- 100 to 400 ft. rolls
- Black or clear finish
- Underlayments are also available at select United Rentals locations. Please contact your representative for further information.



30-CM-5X22

S-Line Concrete Curing Mat

- 5' X 22' Curing Mat
- 6" overlap flap to ensure complete coverage

30-CM-5X22

Rebar Concrete Reinforcing Bar

- Available in sizes 3 through 8:
#3 (3/8" dia.) #5 (5/8" dia.) #7 (7/8" dia.)
#4 (1/2" dia.) #6 (3/4" dia.) #8 (1" dia.)
- Choice of steel grades 40 or 60
- 20 ft. length rods
- Additional sizes and special orders are available, please contact your representative for more information
- Sold by the ton

Please Call For Current Market Price